

CUSTOMER PART No.

CUSTOMER

# CAN ART STD.

DIE No.

EH05423

DESCRIPTION

1 1/2" x 5/8" x 0.062" THK. RECT. TUBE

PROPOSAL No.

H-3239

NOTE: BREAK ALL CORNERS WITH 0.015" (.38 MM) RADIUS UNLESS OTHERWISE NOTED. STANDARD TOLERANCES TO APPLY UNLESS OTHERWISE SPECIFIED.

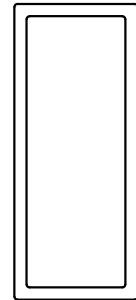
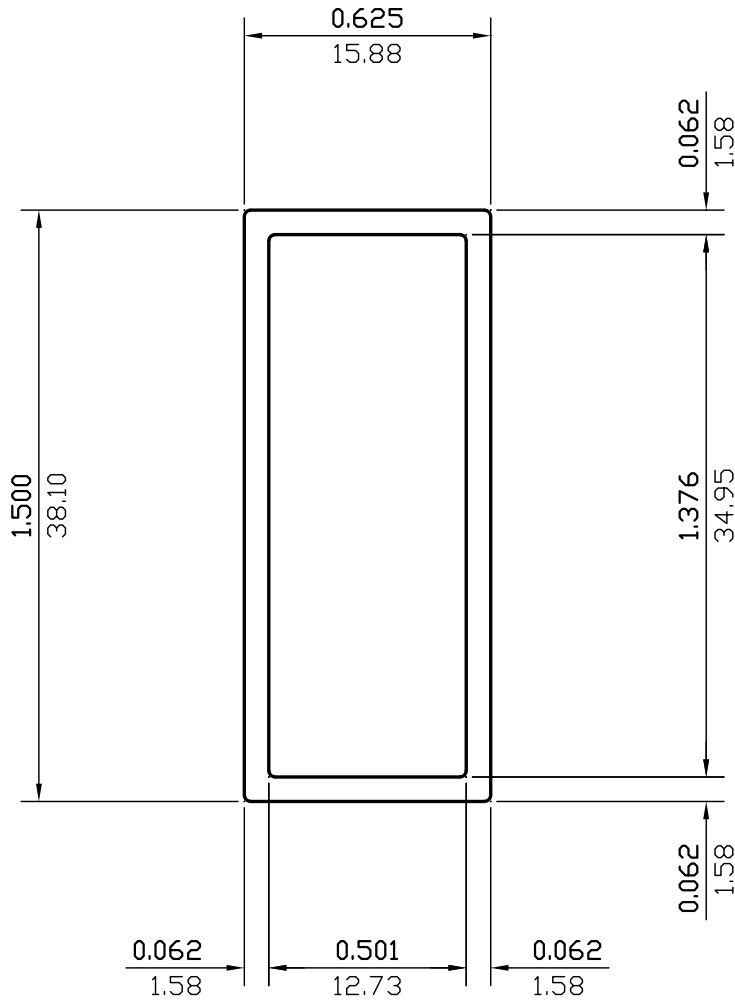

ACTUAL SIZE

WALL THICKNESS 0.062 (1.58) EXCEPT AS SHOWN

DATE	REV	DESCRIPTION	BY
03/14/23	2	REMOVED ALLOY	JASON
08/12/99	1	REDRAWN	P.M.
EST.AREA	0.248	IN. <sup>2</sup>	EST.AREA 160
			MM. <sup>2</sup>
EST.WT.	0.293	LBS./FT.	EST.WT. 0.436
			KG/M.
EST.PER.	8.004	IN.	EST.PER. 203.3
			MM.
OUT PER.	4.250	IN.	OUT PER. 108.0
			MM.
C.C.D.	1.625	IN.	C.C.D. 41
			MM.
FACTOR	27	FINISH	M/F
		ALLOY & TEMP.	
CKD BY	SCALE 2:1	DWN BY	C.P. DATE 09/23/93

## CAN ART

ALUMINUM EXTRUSION INC.

85 PARKSHORE DRIVE  
BRAMPTON, ONT L6T 5M1  
TEL. NO. (905) 791-1464  
FAX NO. (905) 791-9151  
E-MAIL: canart@canart.com

THIS DRAWING IS NOT NECESSARILY A COPY OF YOUR ORIGINAL. PLEASE APPROVE DIMENSIONS AND TOLERANCES INDICATED. CAN ART ASSUMES NO RESPONSIBILITY EITHER TECHNICAL OR LEGAL FOR HAVING THIS SHAPE MADE. THE CUSTOMER AGREES TO FULLY PROTECT CAN ART ALUMINUM FROM CLAIMS OF OTHERS RESULTING FROM THIS SHAPE.

SIGNED: \_\_\_\_\_ DATE: \_\_\_\_\_